



## BACK BAR COOLER

MODEL ZBB60-S2  
Sliding Glass Door



### **i** TECHNICAL SPECIFICATIONS

Voltage/Frequency	220V/50Hz
Refrigerant	R290
Type of Defrost	Automatic
Interior Material	Stainless Steel
Exterior Material	Black Textured Finish
Temperature Range °F	33 ~ 38°F
Compressor Power (HP)	1/3
Nema Config.	NEMA5-15P



### PRODUCT FEATURES

-  The side mount compressor structure is placed in an easy access area, provides quick and convenient access.
-  R290 Natural Refrigerant promotes faster cool down and efficient energy consumption.
-  Precision digital temperature controls allow pinpoint accuracy with temperatures from 33-38°F.
-  Stainless steel top, sealed interior floors, and rounded cabinet corners for easy cleaning.
-  Adjustable, heavy-duty epoxy coated shelves.
-  Constructed of commercial-grade body panels in black textured finish to fit all decors and living spaces.
-  Featured in a large size and double pane tempered glass block UV light to safely keep all types of drinks ready to serve.
-  LED interior lighting for bright product display.
-  Optional casters with breaks available upon request for better cleaning and mobility.



### HEAVY-DUTY CABINET FRAME & ROBUST DESIGN



Los Angeles | San Francisco | Dallas  
Houston | Florida | Chicago | New Jersey

+1(708) 590-9543  
info@zuilex.com  
www.zuilex.com

# DETAILS & SPECIFICATIONS

## BACK BAR COOLER

Front View

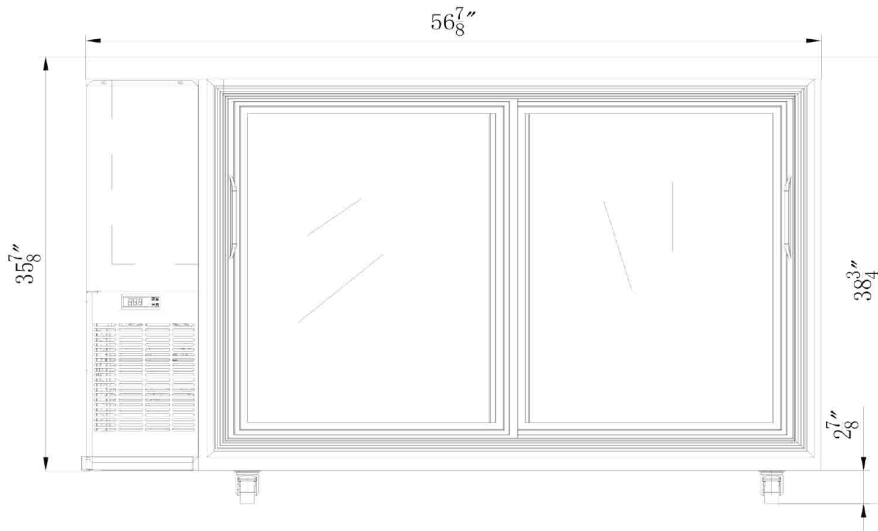

Side View

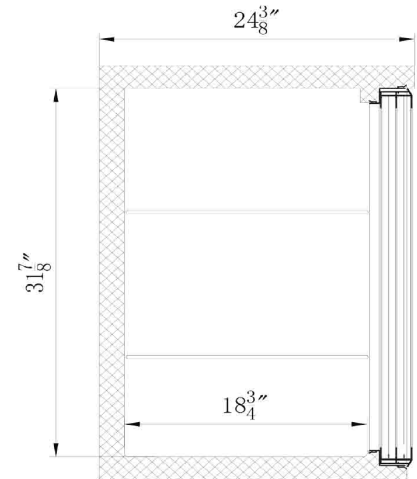

Rated Voltage	220 V
Rated Frequency	50 Hz
Total Input Power	284W
Total Current	2.66A
Total Capacity	15.24 cu ft
Climatic Category	4-5
Protection Type	I
Design Pressure High Side	385 PSIG
Design Pressure Low Side	150 PSIG
Insulation Blowing Gas	C-Pentane
Refrigerant	R290/3.53 oz



MODEL	EXTERNAL DIMENSION WXDXH (INCHES)	PACKAGING DIMENSION WXDXH (INCHES)	PRODUCT NET WEIGHT	# OF SHELVES	40FT (PCS)
ZBB60-S2	56 7/8"x24 3/8"x38 3/4"	63 1/2"x26 3/8"x43 1/4"	220 lbs	6	48



Los Angeles | San Francisco | Dallas  
Houston | Florida | Chicago | New Jersey

+1(708) 590-9543

info@zuilex.com

www.zuilex.com