



# BACK BAR BEVERAGE COOLER

MODEL ZBB72-M3

Solid Door



## PRODUCT FEATURES

- Digital controller and temperature display. To save energy and reduce heat production, the unit has fans with electronically commutated motors that circulate cold air.
- Temperatures in the cabinet range from 33 to 38 degrees Fahrenheit
- Each of the doors has an exterior made from laminated black vinyl, which matches the rest of the cabinet's exterior. The front and sides of the unit are covered in a wear-resistant laminated black vinyl that complements the stainless steel countertop bar area.
- Heavy-duty casters with brakes are included providing the unit with convenient mobility, making cleaning and servicing a breeze! Just roll the unit away from the wall.
- Heavy-duty gaskets on the doors prevent cold air from leaking out, while polyurethane insulation keeps warm air from seeping in.
- To accommodate various products has six black PVC-coated wire shelves that are adjustable in 1/2-inch increments.



## TECHNICAL SPECIFICATIONS

Voltage/Frequency	220V/50Hz
Refrigerant	R290
Type of Defrost	Automatic
Interior Material	Stainless Steel
Exterior Material	Stainless Steel
Temperature Range °F	33 ~ 38°F
Compressor Power (HP)	1/5
Nema Config.	NEMA5-15P



## HIGH QUALITY STAINLESS STEEL & ROBUST DESIGN



Los Angeles | San Francisco | Dallas  
Houston | Florida | Chicago | New Jersey

+1(708) 590-9543  
info@zuilex.com  
www.zuilex.com

# DETAILS & SPECIFICATIONS

## BACK BAR BEVERAGE COOLER

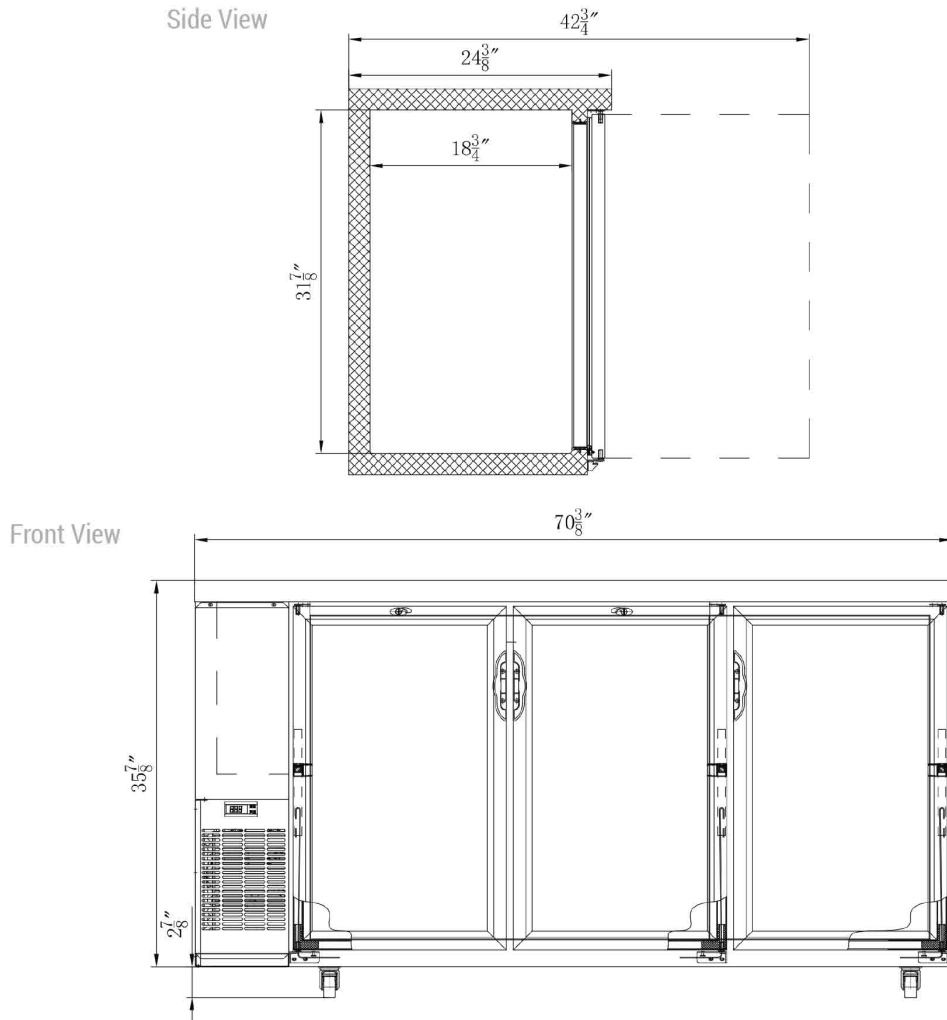

MODEL	EXTERNAL DIMENSION WXDXH (INCHES)	PACKAGING DIMENSION WXDXH (INCHES)	PRODUCT NET WEIGHT	# OF SHELVES	40FT (PCS)
ZBB72-M3	$70\frac{3}{8}$ "x $24\frac{3}{8}$ "x $38\frac{3}{4}$ "	$75\frac{3}{8}$ "x $26\frac{3}{8}$ "x $43\frac{1}{4}$ "	330 lbs	6	36

\* All measures are presented in inches and pounds



Los Angeles | San Francisco | Dallas  
Houston | Florida | Chicago | New Jersey