

2-in-1 Car Multimedia Adapter

# User Guide

(CM01)

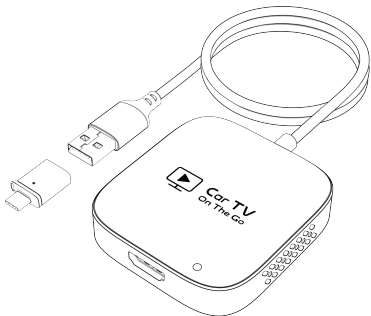

# Contents

Important Instructions	1
What's in the Box	2
Technical Specification	2
How to Use	2
Car multimedia functionality	3
CarPlay functionality	4
How to Switch Systems	7
Online Firmware Upgrade	7
FAQs & Troubleshooting	9
Life Time Customer Support	11
Extended Warranty	11

## Important Instructions

Please read this manual carefully before using the device, and retain it for future reference.

- **Function Usage Limitation:** The multimedia functionality and CarPlay cannot be used simultaneously.
- **Network Requirements:** Any streaming device requires an internet connection. Please connect to a mobile hotspot or mobile Wi-Fi network.
- **Device Requirements:** The CarPlay functionality is only compatible with iPhone 6 or newer, and iOS 10 or newer.
- **Vehicle Requirements:** Only compatible with vehicles with CarPlay as a factory-installed feature.

### How to Verify Your Car Supports CarPlay

**Method 1:** Check if the CarPlay logo appears in your car's infotainment menu. If not, connect your iPhone to the car's system with a USB cable and check again.

**Method 2:** Check out this website for supported car models <https://www.apple.com/ios/carplay/available-models/> or scan the QR code below to check for supported models.



CarPlay

**Method 3:** Contact your car dealer for help.

## What's in the Box

- 1 x Car Multimedia Adapter
- 1 x USB-A Female to USB-C Male Adapter
- 1 x User Guide
- 1 x Warranty Card

## Technical Specification

**CPU:** Cortex A7 1.0GHz

**DDR:** 64MB DDR2

**System:** Linux

**Input voltage:** DC 5V  $\pm$  0.3A

**Wi-Fi format:**

WEP/WPA2/WPA3-SAE PERSONAL MFP

**Bluetooth version:**

Bluetooth 5.2, compatible with 2.1 + EDR/3.0/4.X/5

**Bluetooth & Wi-Fi module frequency:**

Bluetooth 2.4 GHz, Wi-Fi 2.4 - 5.8 GHz

## How to Use

**Indicator Light Status:**

- Red Light Flashing: Booting up
- Blue Light Flashing: Started, waiting for pairing
- Blue Light on: Connected

## Car multimedia functionality

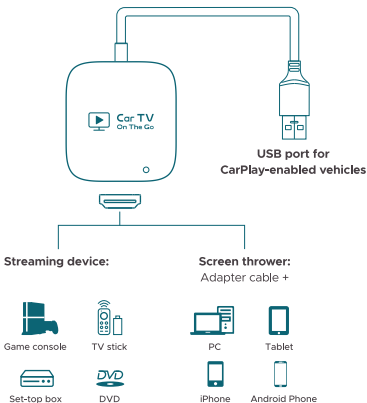

**Step 1:** Start the car and wait for the car engine system to load.

**Step 2:** Connect the adapter to the car's USB-A or USB-C port and then go to the selection interface. Click "HDMI" and the screen will display "No Signal."



### Step 3:

- **Streaming device:** Insert the HDMI male connector of the TV stick/Set-top box/Game console into the HDMI female port of the adapter, and provide power to the input device. (\*Note: Streaming devices require an internet connection.)
- **Screen thrower:** Insert an HDMI to HDMI cable/Lightning to HDMI cable/USB-C to HDMI cable, and you can mirror the screen of your computer/iPhone/Android phone to the car display. (\*Note: Mobile devices need to support video output.)

**Step 4:** After a successful connection, wait for the system to enter the interface automatically.

## CarPlay functionality

### Bluetooth & Wi-Fi signal names:

Car-Play-XXXX (XXXXXX is the Serial number provided with products)

**Step 1:** Start the car and wait for the car engine system to load.

**Step 2:** Connect the adapter to the car's USB-A or USB-C port and then go to the selection interface. Click "CarPlay" to enter the guide page.

**Step 3:** Turn on Bluetooth and Wi-Fi on your iPhone, ensuring they are not connected to other devices.

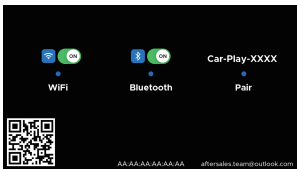

**Step 4:** Follow the iPhone screen prompts to connect to the Bluetooth signal "Car-Play-XXXXX" and pair. (No need to connect to Wi-Fi, just keep it on.)

### Allow Contacts and Favourites Sync?

Your car may request your contacts, phone favourites and recent phone calls over Bluetooth. Do you wish to allow this? CarPlay will work without syncing.

Don't Allow

Allow



## Bluetooth Pairing Request

"Car-Play-XXXX" would like to pair with your iPhone. Confirm that this code is shown on "Car-Play-XXXX". Do not enter this code on any accessory.

XXXXXX

Cancel

Pair



## Use CarPlay with "Car-Play-XXXX"?

CarPlay automatically connects your iPhone to your car's built-in display, and can access your phone while it is locked.

Not Now

Use CarPlay



**Step 5:** After confirmation, wait for the system to enter the CarPlay interface automatically.

## How to Switch Systems

### HDMI→CarPlay

Click the back icon (←) in the upper left corner to return to the selection interface for switching.

### CarPlay→HDMI

To switch to HDMI, click the app with your vehicle brand logo or the 'HOME' app on the infotainment screen to return to the selection interface.

## Online Firmware Upgrade

1. This update is only for the CarPlay functionality.
2. If the adapter works properly, it means the current version is compatible with your car.
3. Only try this solution when the problem you encounter cannot be resolved by the solutions in the "FAQs" list.
4. If the car multimedia adapter has problems after updating, please "Restore factory settings".

### Upgrade Steps/ Enter the Settings Interface

1. Power up the adapter, it is recommended to use the charging-only port.
2. Connect the adapter's WiFi (WiFi signal name: Car-Play-XXXXX), the password is "88888888".
3. Open Safari and enter "192.168.1.101", then tap "Update".
4. On the same page, you could also fill in the car make, model years, and issue details, next tap "Submit" to report the issue. Our engineers will document your problem and research possible solutions.

5. After the upgrade is complete, please restart the phone once before using the adapter.

**\*If the update fails, please try the following:**

- A. Turn off your phone's Bluetooth;
- B. Enter the phone's WLAN settings and forget the network of the adapter;
- C. Research and re-connect the "Car-Play-XXXX" in the phone's WiFi list;
- D. Try to update again on "192.168.1.101".

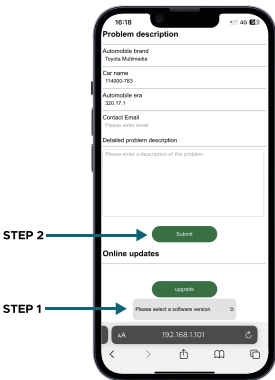

## FAQs & Troubleshooting

### 1. The car's screen displays "No Signal"?

- The signal source is not inserted. Please plug in a device such as a TV stick/Set-top box/Game console.
- Check the connection to ensure it is secure; clean the port to ensure there is no dust.

### 2. The audio is intermittent, delayed, or has no sound when watching videos.

Because video transcoding is more complex than normal audio file transcoding and takes longer to process, the sound will be delayed as a normal problem with car multimedia and CarPlay, not the adapter's problem. If there is no sound, please try unplugging and reconnecting the device.

### 3. Unable to play Netflix?

Some Netflix subscription plans do not allow users to stream content from mobile devices to the TV. To function properly, you need to upgrade your subscription to either the Standard or Premium plan.

### 4. Why is my Nintendo Switch not working?

- Nintendo Switch cannot output video using a USB-C to HDMI cable. You need to use the HDMI to HDMI cable connected to the dock for video output.

- This adapter connects to the Switch Dock and requires a PD protocol-supported charger with an output voltage of 15V and a minimum power of 20W. Inexpensive car chargers that do not meet these specifications will not power the Switch. Please replace it with a suitable car charger.

## **5. The indicator light of the adapter is still on after the car is turned off.**

Because the car will not cut off all the power immediately when it is turned off, the light of the adapter will not go out immediately, but it will take a while. Please rest assured that its power consumption is minimal and will not drain the car battery.

## **6. What is the password to connect to WiFi?**

What we need to connect is Bluetooth, not WiFi, no password is required for connecting to Bluetooth. Make sure your WiFi is turned on and unoccupied when pairing.

## **7. Can the adapter be paired with multiple phones?**

The adapter can be paired with multiple Phones, but only one device can be connected at a time. If you would like to pair it with a new Phone, please cancel the current connection first. Please note, by the Bluetooth function default, the adapter's system will only auto-connect back to the last phone used.

## Life Time Customer Support

If there is any issue while using our product or any dissatisfaction, welcome to contact us and give us an opportunity to make it right:

- E- mail: [aftersales.team@outlook.com](mailto:aftersales.team@outlook.com)
- "Ask a question" on Amazon seller page
- "Contact seller" on the order page

You will get fast and friendly support within 18hrs even during weekends and holidays.

## Extended Warranty

- We provide a 12-month extended warranty policy, beyond Amazon's basic 30-day return window.
- Following the guidelines of the warranty card in the package, register for an additional 12 months of extra warranty for a total of 24 months.